

PROJECT INTRODUCTION + CONTEXT

Project Area



Project Scope

- Roadway geometry and intersection improvements
- New widened sidewalk, new curb and gutter
- Full width resurfacing with new pavement markings
- Protected bike lanes
- New pavers and trees on parkways
- New street lighting
- Upgrades to ADA ramps and crosswalks
- Drainage improvements
- New street furniture and seating areas
- Installation of community light pole identifiers and gateway identifiers
- Creation of Ainslie Arts Plaza: permanent closure of Lincoln Ave between Gunnison St and Ainslie Ave
- Creation of Catalpa Plaza
- Creation of space in the public way for art installations

Project Schedule

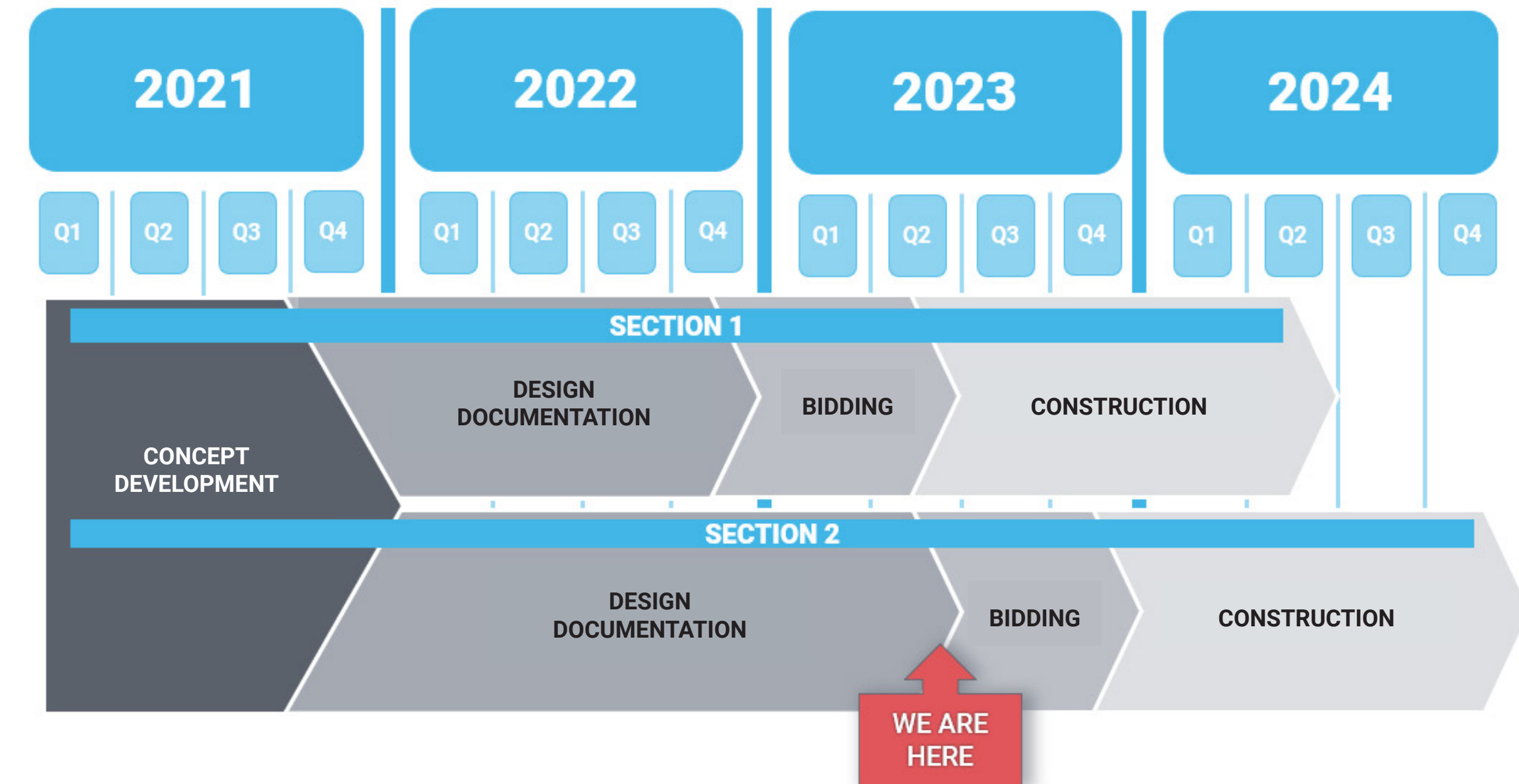

Community Outreach Events + Activities

DATES	EVENTS
June 24, 2021	Task Force Mtg #1
July 27, 2021	Public Mtg #1
Jun 25 - Jul 20, 2021	Poll #1
Aug 18, 2021	Task Force Mtg #2
Oct 13, 2021	Public Mtg #2
Oct 13 - Nov 18, 2021	Poll #2
April 13, 2022	Task Force Mtg #3
May 12, 2022	Public Mtg #3

Community Outreach Highlights

Participation

PUBLIC MEETING 1 / POLL 1
1,350 + PARTICIPANTS
1,100+ COMMENTS

PUBLIC MEETING 2 / POLL 2
900 + PARTICIPANTS
1,500+ COMMENTS

Key Takeaways

- Safety is top priority
- Widen sidewalks
- Add bike facilities
- Incorporate greening
- Be sustainably-minded
- Narrow Catalpa Avenue
- Add community vibrancy and color
- Keep it simple

Key Concerns

AUTOMOBILE TRAFFIC CONCERNS



- LINCOLN AVENUE**
1. Traffic congestion
 2. Speeding vehicles
 3. Cut through traffic on neighborhood streets
 4. Availability of parking

- CATALPA AVENUE**
1. Speeding vehicles
 2. Traffic congestion
 3. Cut through traffic on neighborhood streets
 4. Availability of parking

GENERAL TRAFFIC CONCERNS



1. Pedestrian safety/crossings
2. Sidewalk conditions
3. Lack of trees / plantings
4. Traffic flow
5. Bike safety/routes
6. Existing bus stop conditions / amenities
7. Existing street lighting

1. Pedestrian safety/crossings
2. Sidewalk conditions
3. Traffic flow
4. Bike safety/routes
5. Trees and plantings conditions
6. Existing street lighting

THEME, AMENITIES + PRODUCTS



Color Palette



Oak Savanna Spring

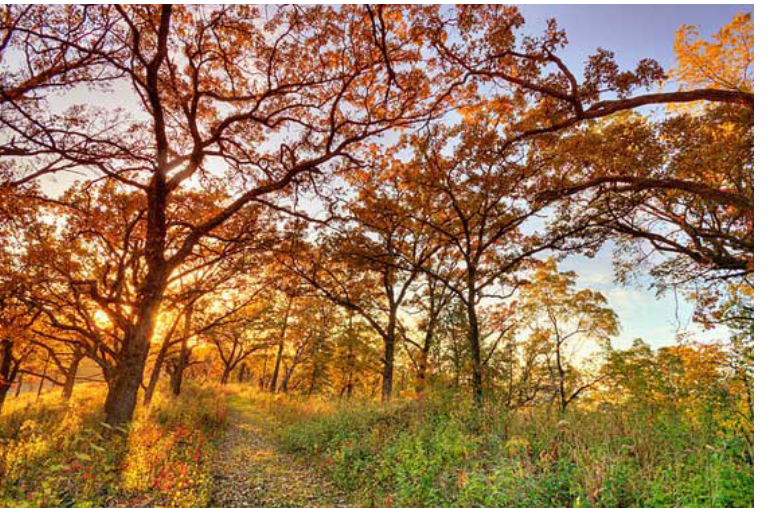

Oak Savanna Fall



Oak Leaf Cell Structure

The design theme references the Oak Savanna landscapes that were native to Lincoln Square and continue to thrive throughout neighborhood open spaces.



Trash Receptacle
Occurs at Streetscape and Plazas

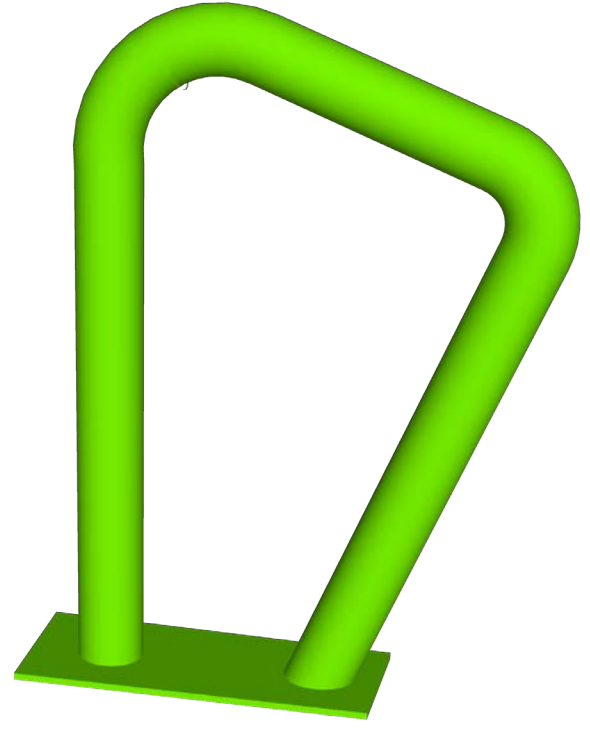

Bike Rack
Occurs at Streetscape and Plazas

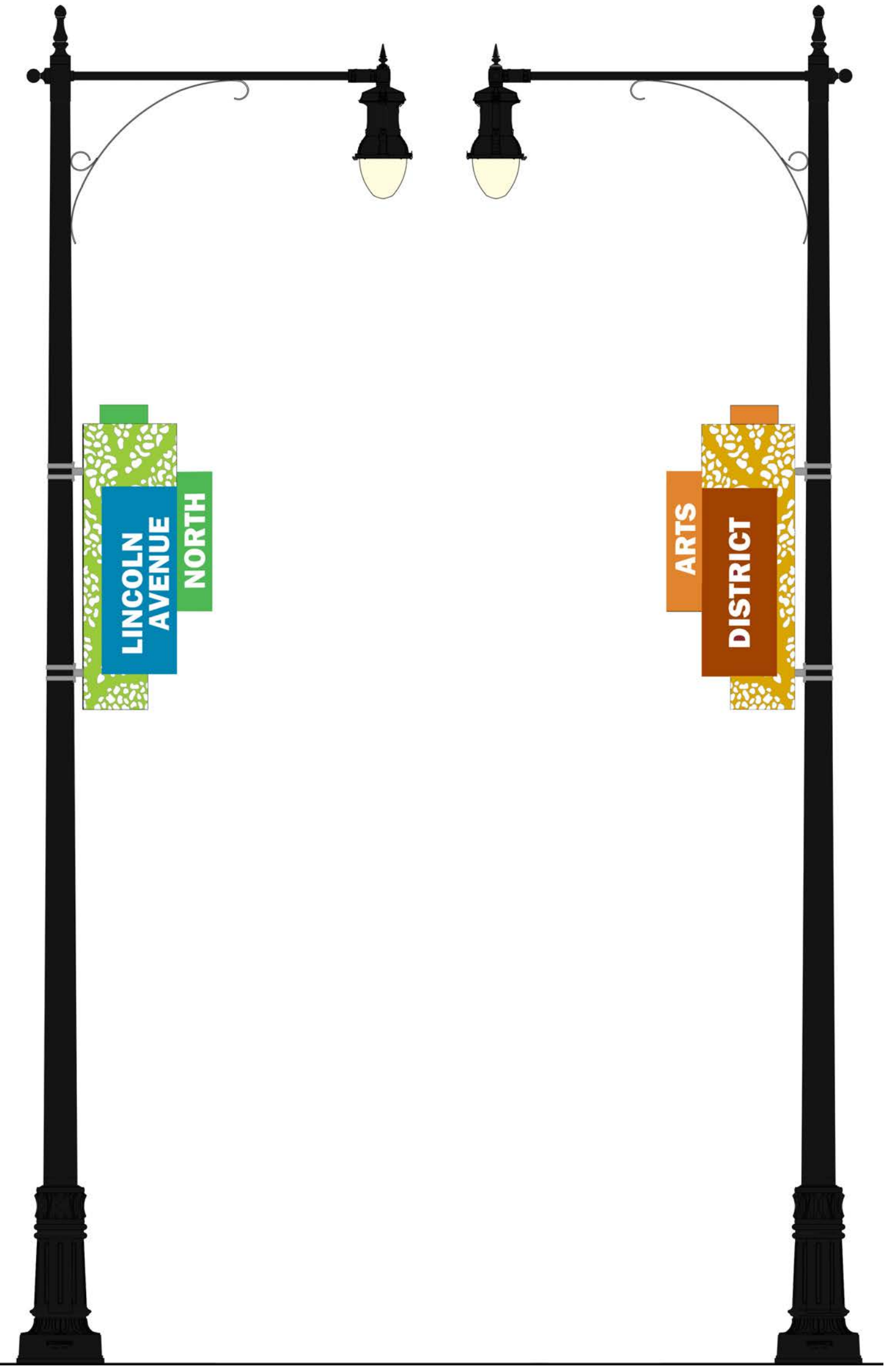

Light Poles and Light Pole Identifiers
Light Poles - occur along streetscape
Light Pole Identifiers - occur along Lincoln Avenue streetscape



Fixed Table and Chairs With Sunshade
Occurs at Ainslie Arts Plaza and Catalpa Plaza

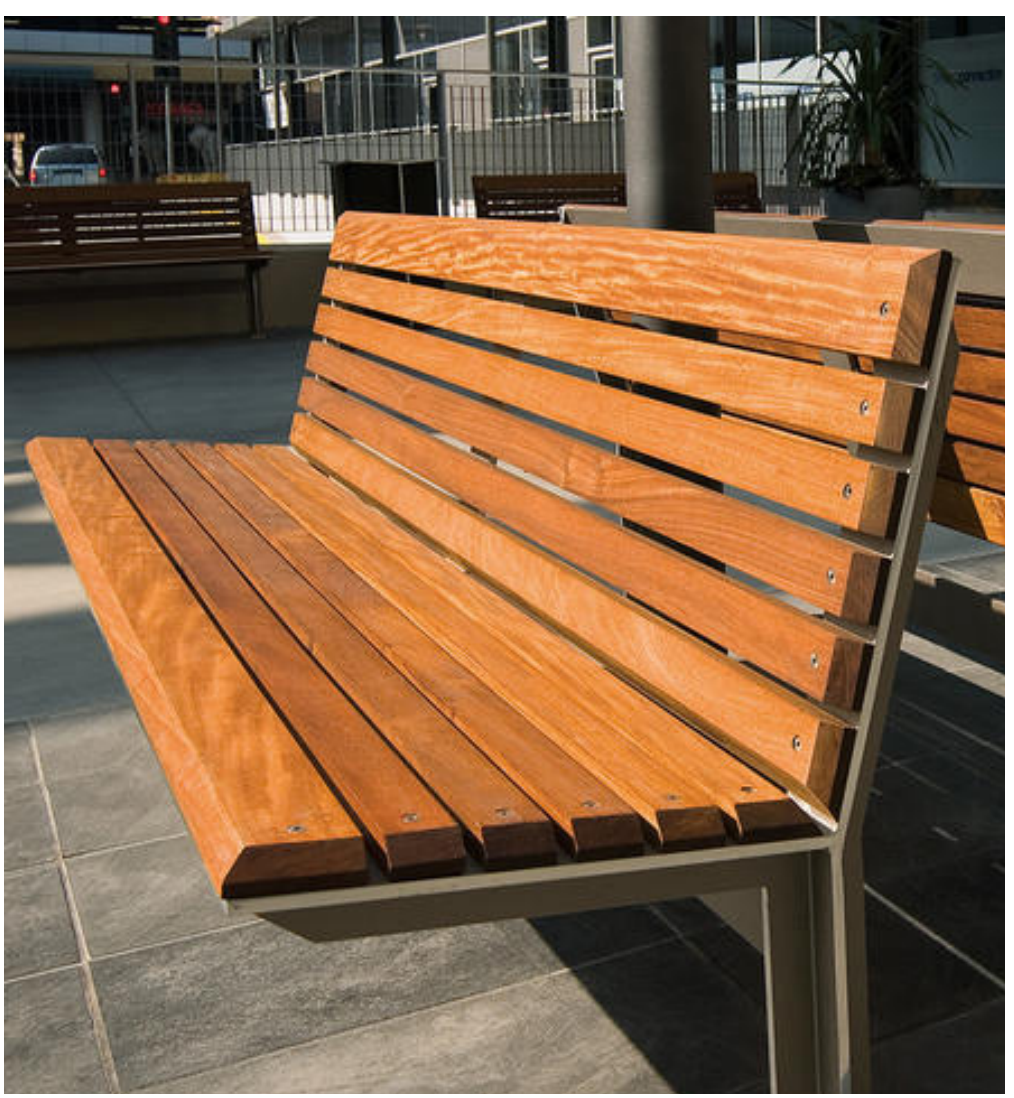

Backed Benches
Occurs at Streetscape and Plazas

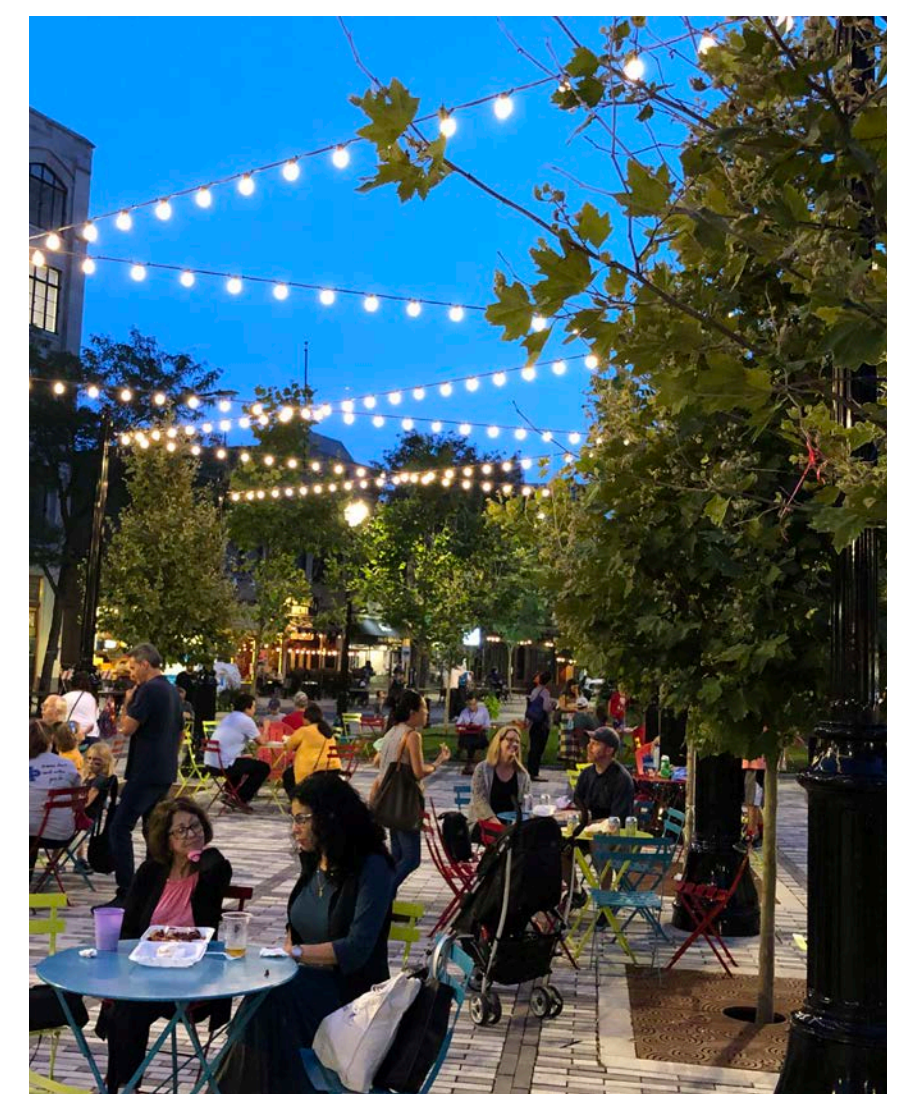

Decorative Festoon Lighting
Occurs at Ainslie Arts Plaza



Freestanding Concrete Planter
Occurs at Ainslie Arts Plaza

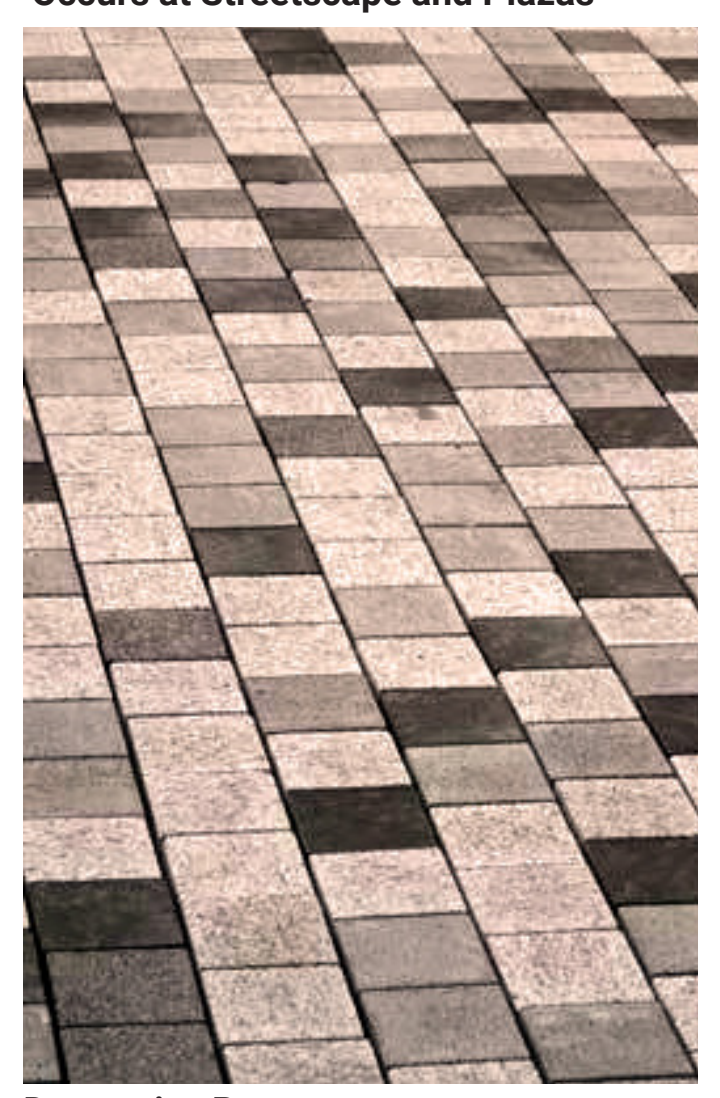

Decorative Pavers
Occurs at Streetscape and Plazas

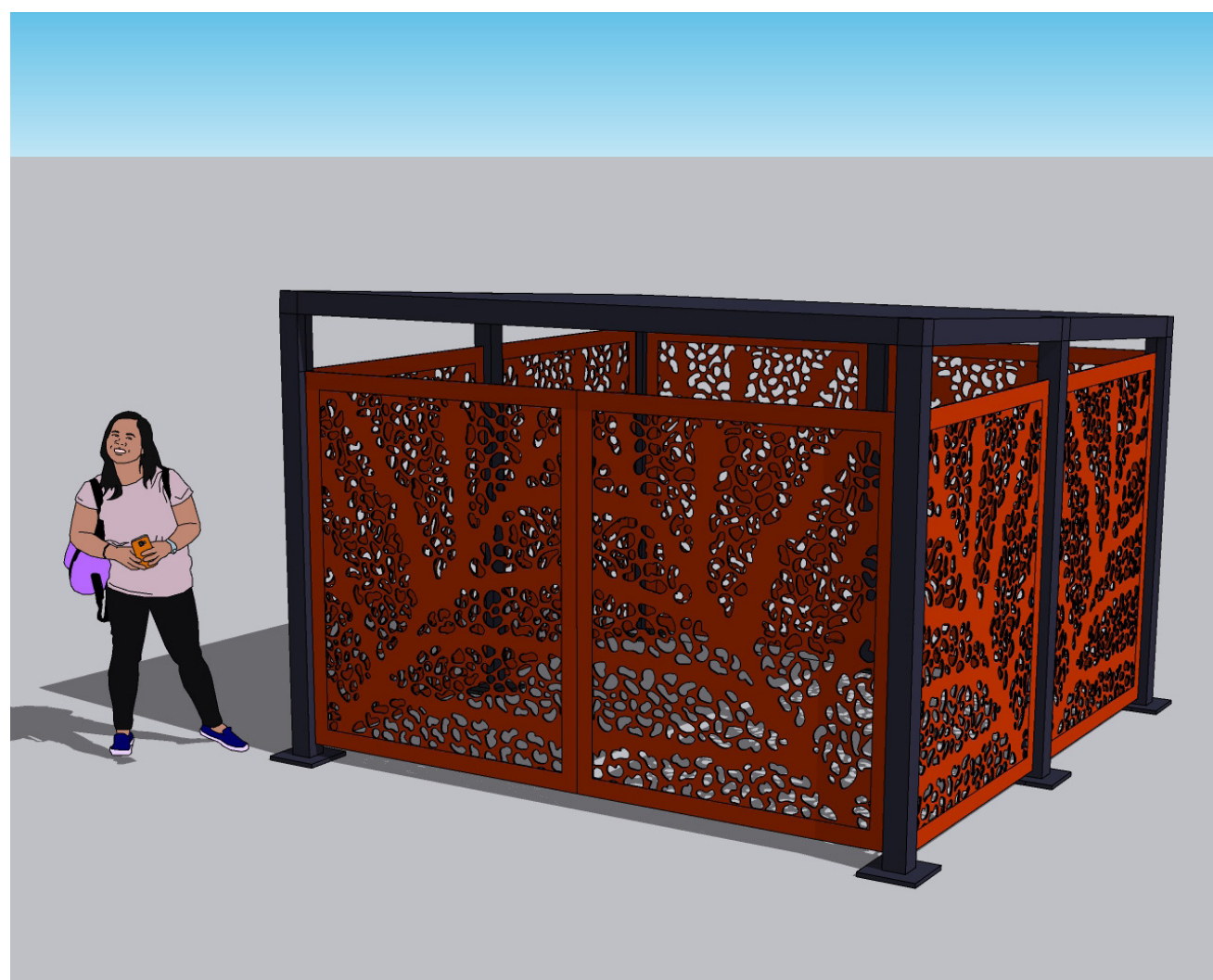

Storage Enclosure With Decorative Screens
Occurs at Ainslie Arts Plaza



Fence With Decorative Screens
Occurs at Ainslie Arts Plaza

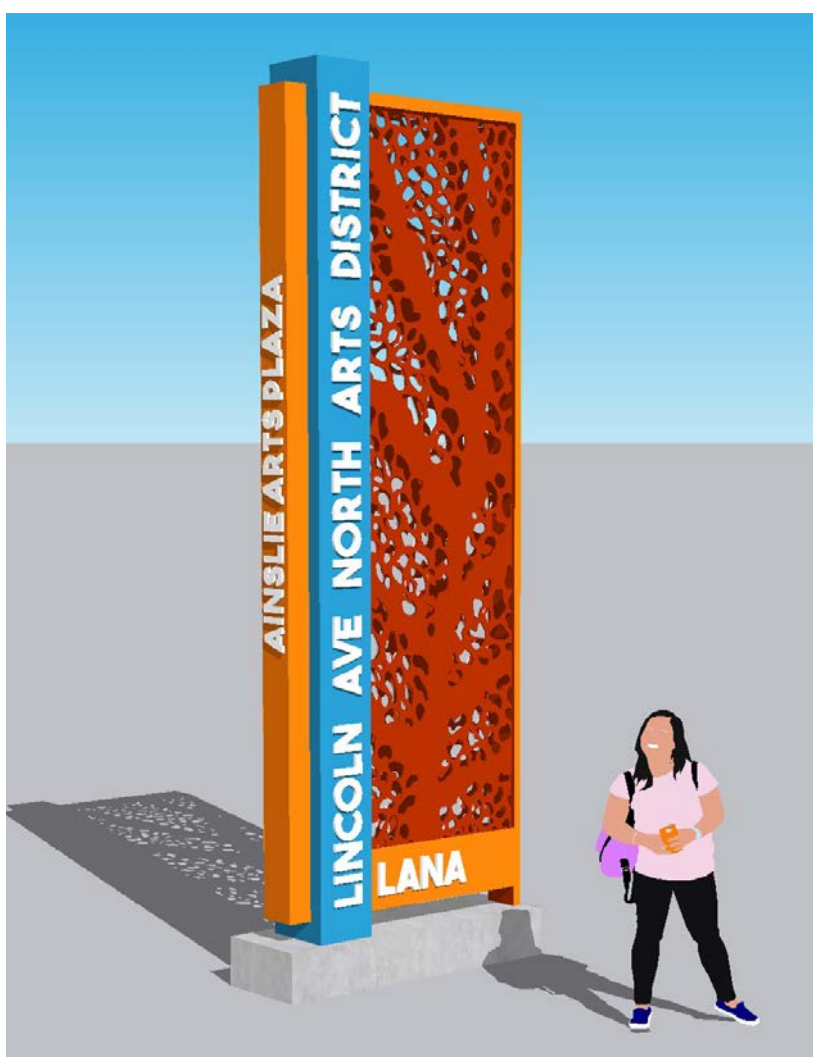

Gateway Pylon
Occurs at Ainslie Arts Plaza

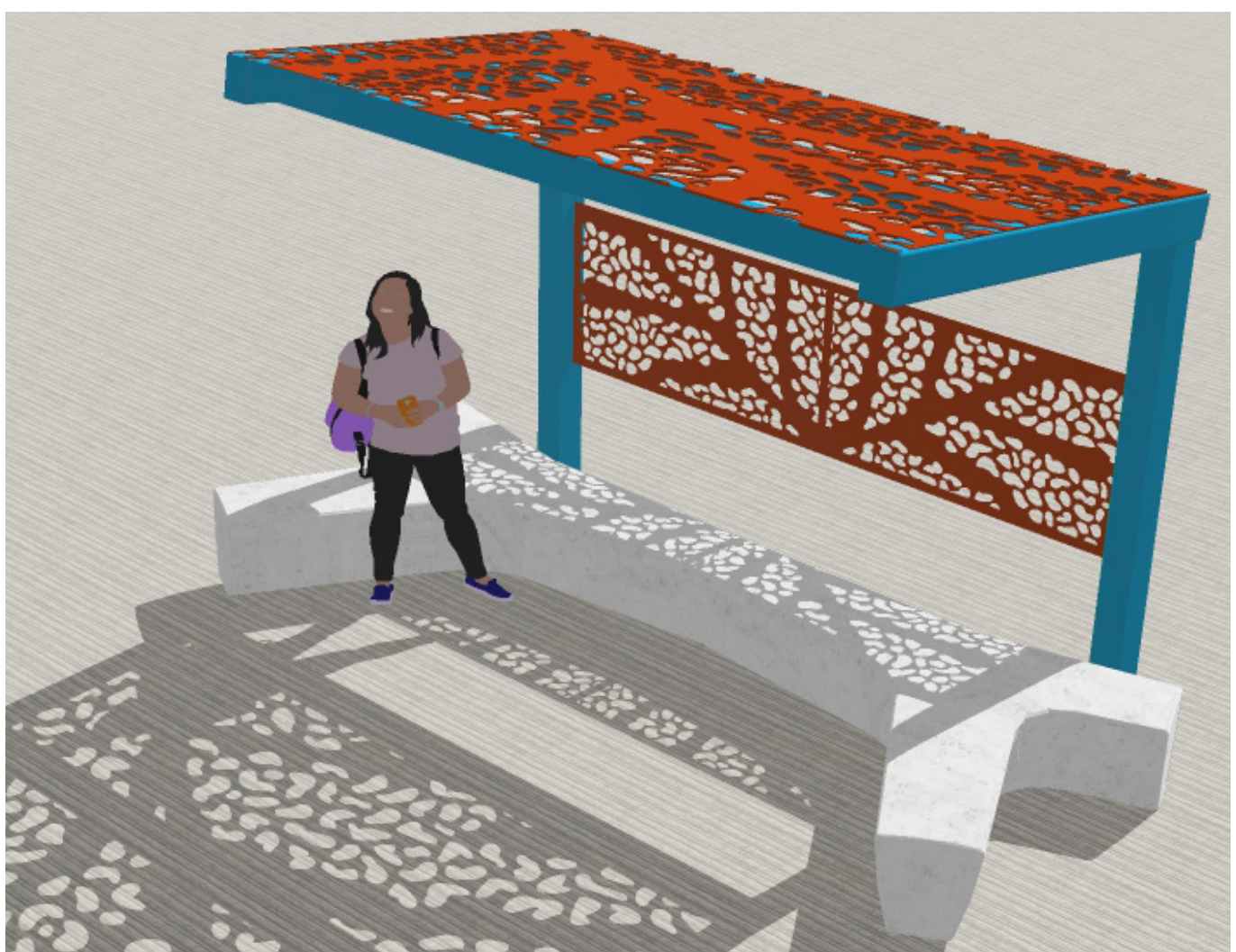

Sculptural Concrete Bench And Shade Structure With Decorative Screens
Occurs at Ainslie Arts Plaza and Catalpa Plaza











Freestanding Decorative Screens
Occurs at Parkway Plazas

LINCOLN AVE STREETSCAPE AND PLAZA



BIKE + TRANSIT NETWORK + TRAFFIC

Legend

-  BUS ROUTE
-  BUS STOP
-  DIVVY STATION
-  PROTECTED BIKE LANES
-  DESIGNATED CROSTOWN BIKE ROUTE
-  PLANNED CROSTOWN BIKE ROUTE (UNBUILT)
-  DESIGNATED NEIGHBORHOOD BIKE ROUTE
-  PLANNED NEIGHBORHOOD BIKE ROUTE (UNBUILT)
-  PROJECT BOUNDARY

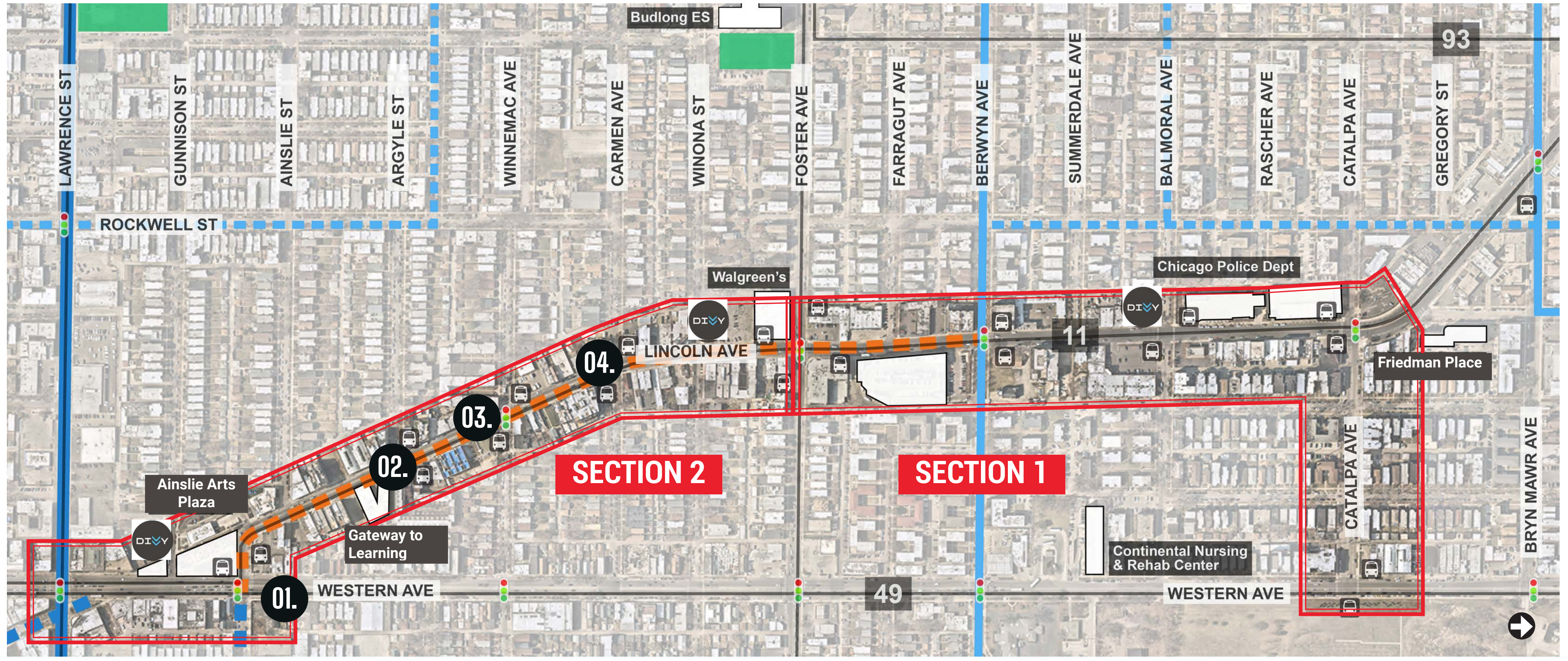

Intersection Traffic Changes

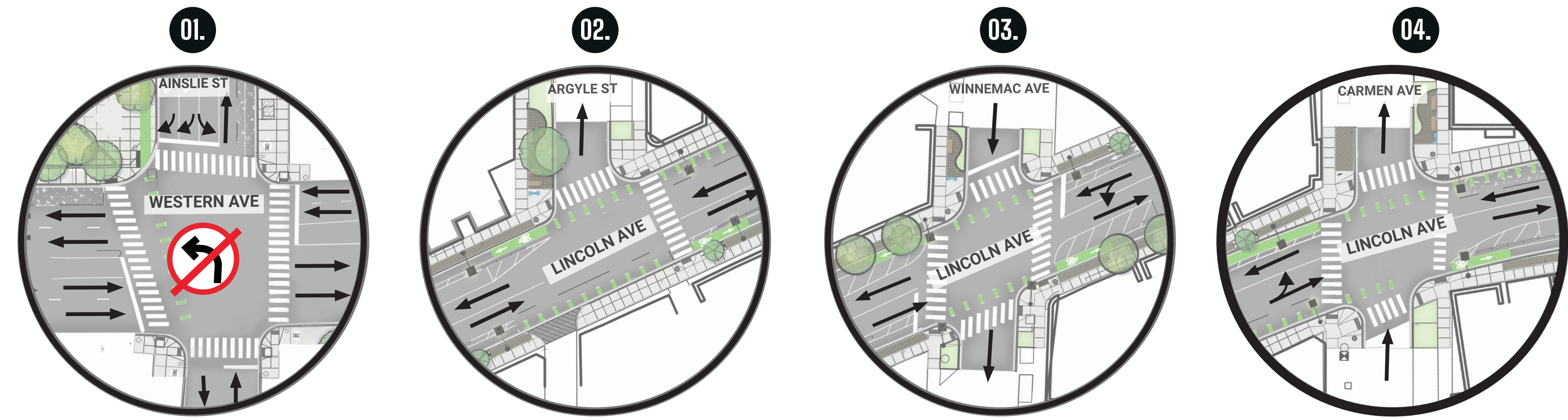

Left-turn movement from WB Ainslie onto SB Western to be prohibited.

Removal of left turn designated lane. Left turn movements continue to be permitted.

LINCOLN AVE STREETScape AND PLAZA



SECTION 1: LINCOLN AVENUE DESIGN + TYPICAL SECTIONS



- LEGEND**
- PROTECTED BIKE LANES
 - PARKING
 - PARKWAY PLAZAS
 - BUS STOPS
 - TRAFFIC SIGNALS

Lincoln Ave Existing

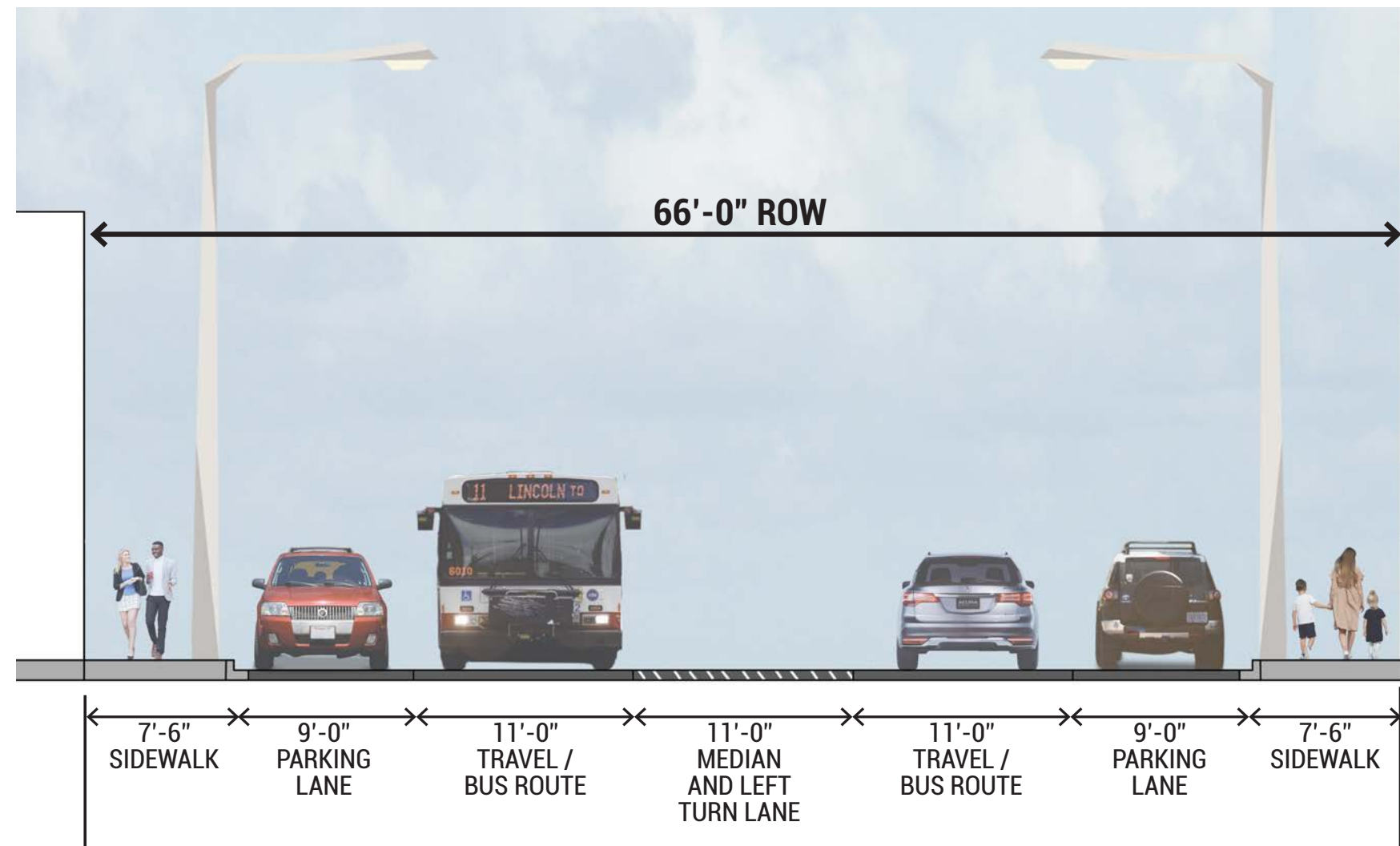

Catalpa Ave Existing

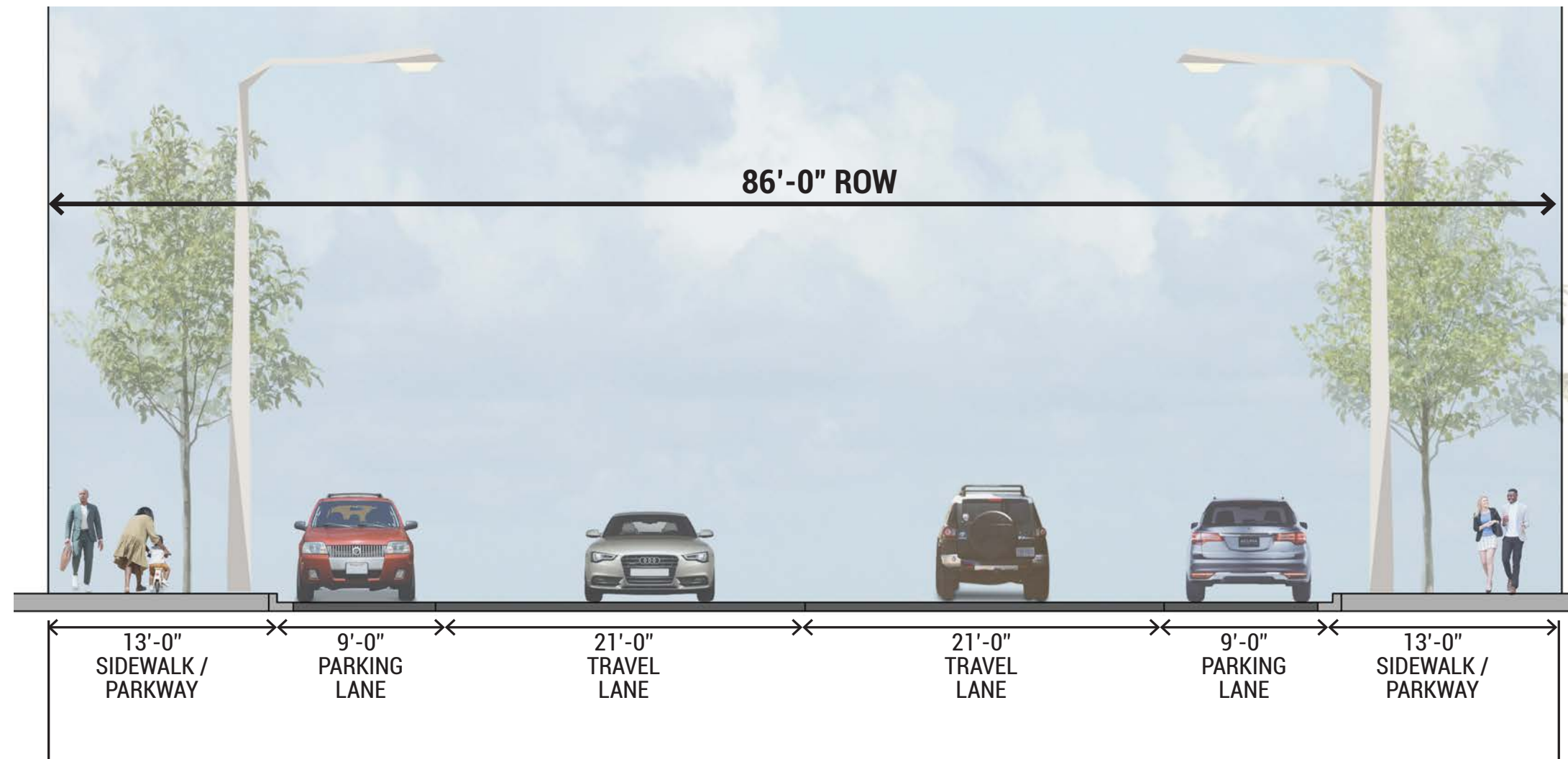

Lincoln Ave Proposed Section A

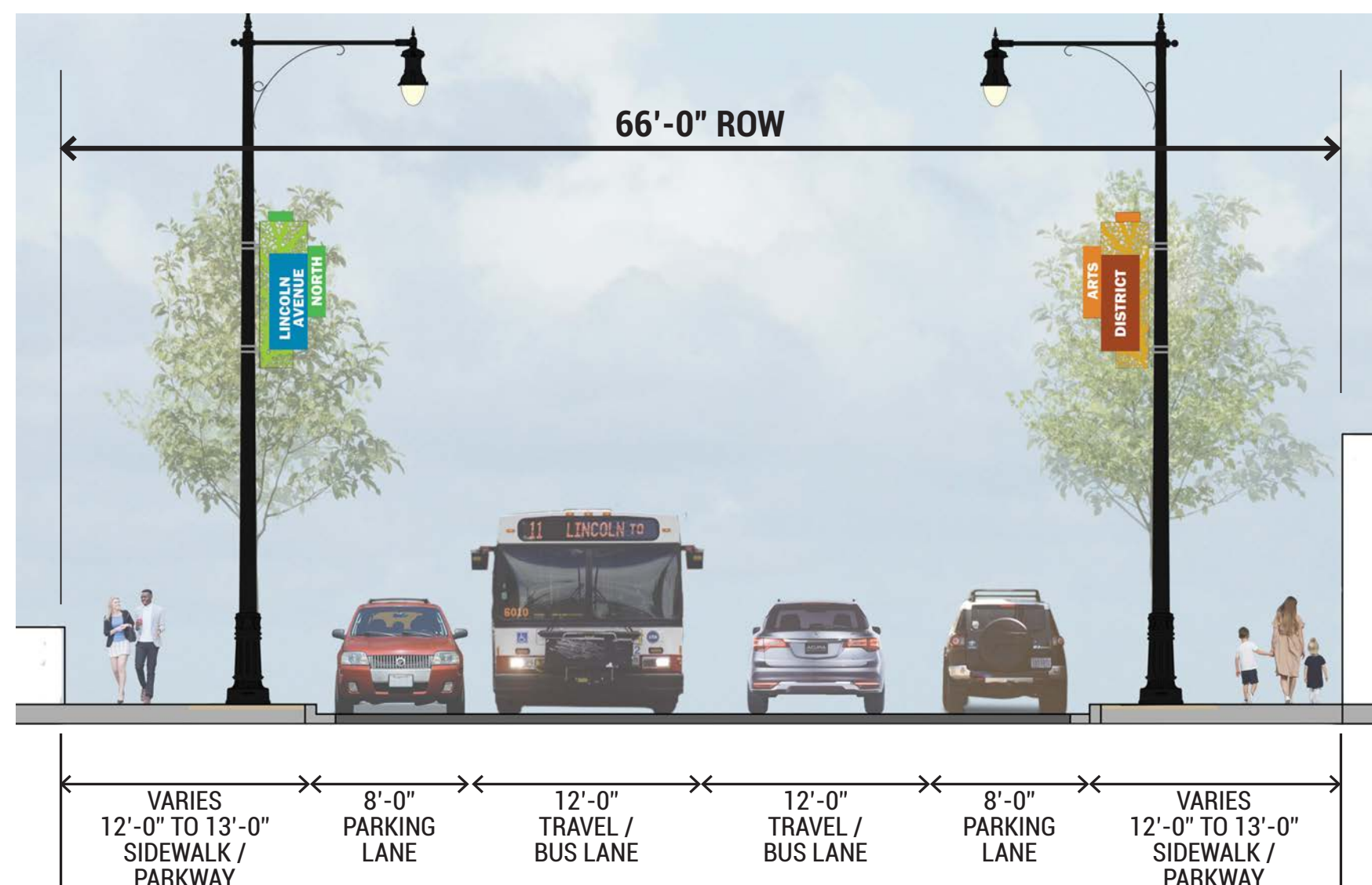

Catalpa Ave Proposed Section B

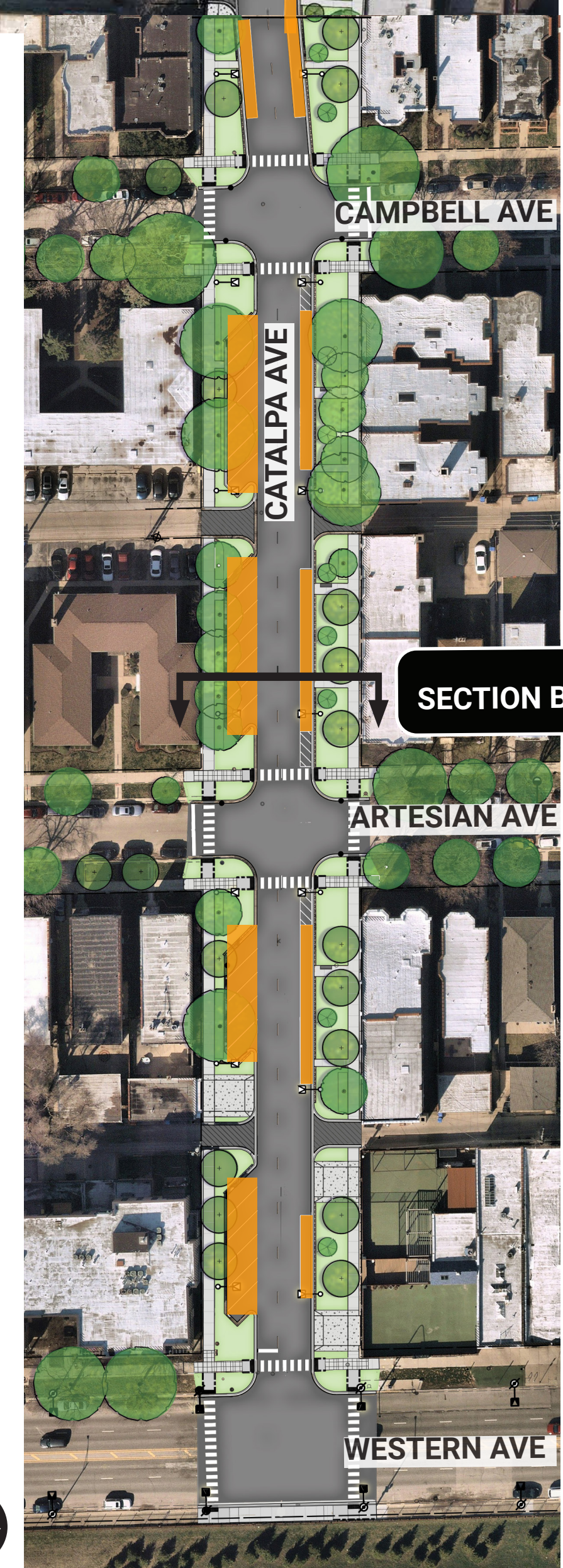
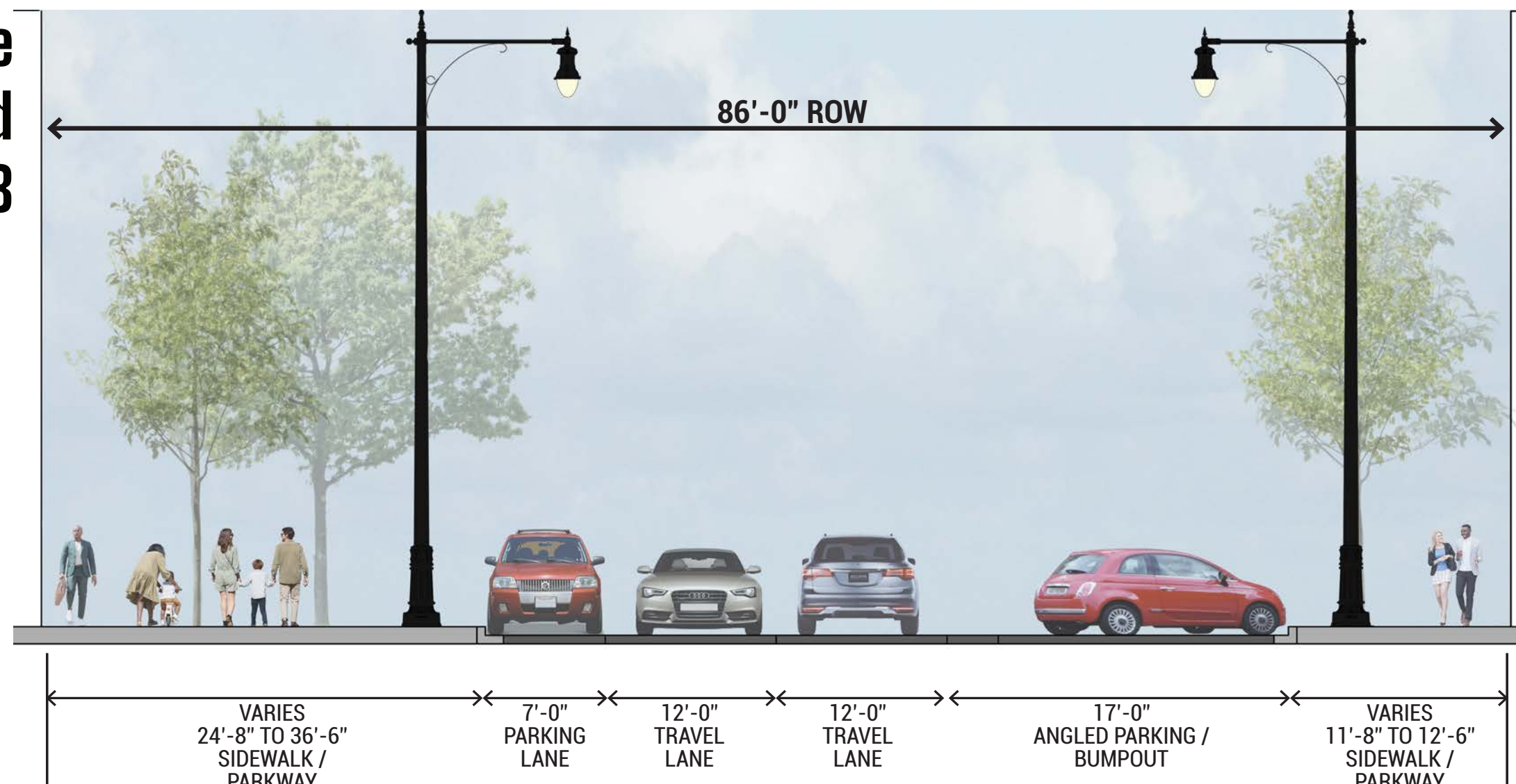

CATALPA AVENUE IMPROVEMENTS

Catalpa Ave Enlargement

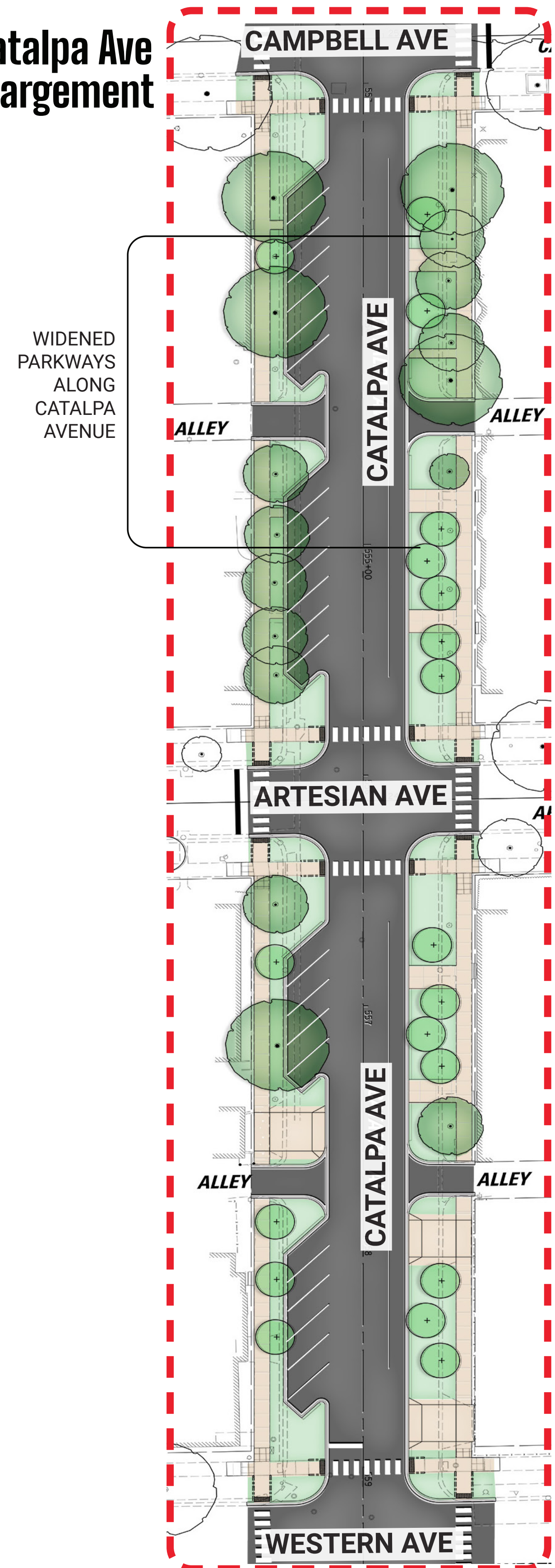

Catalpa Ave Plaza Plan

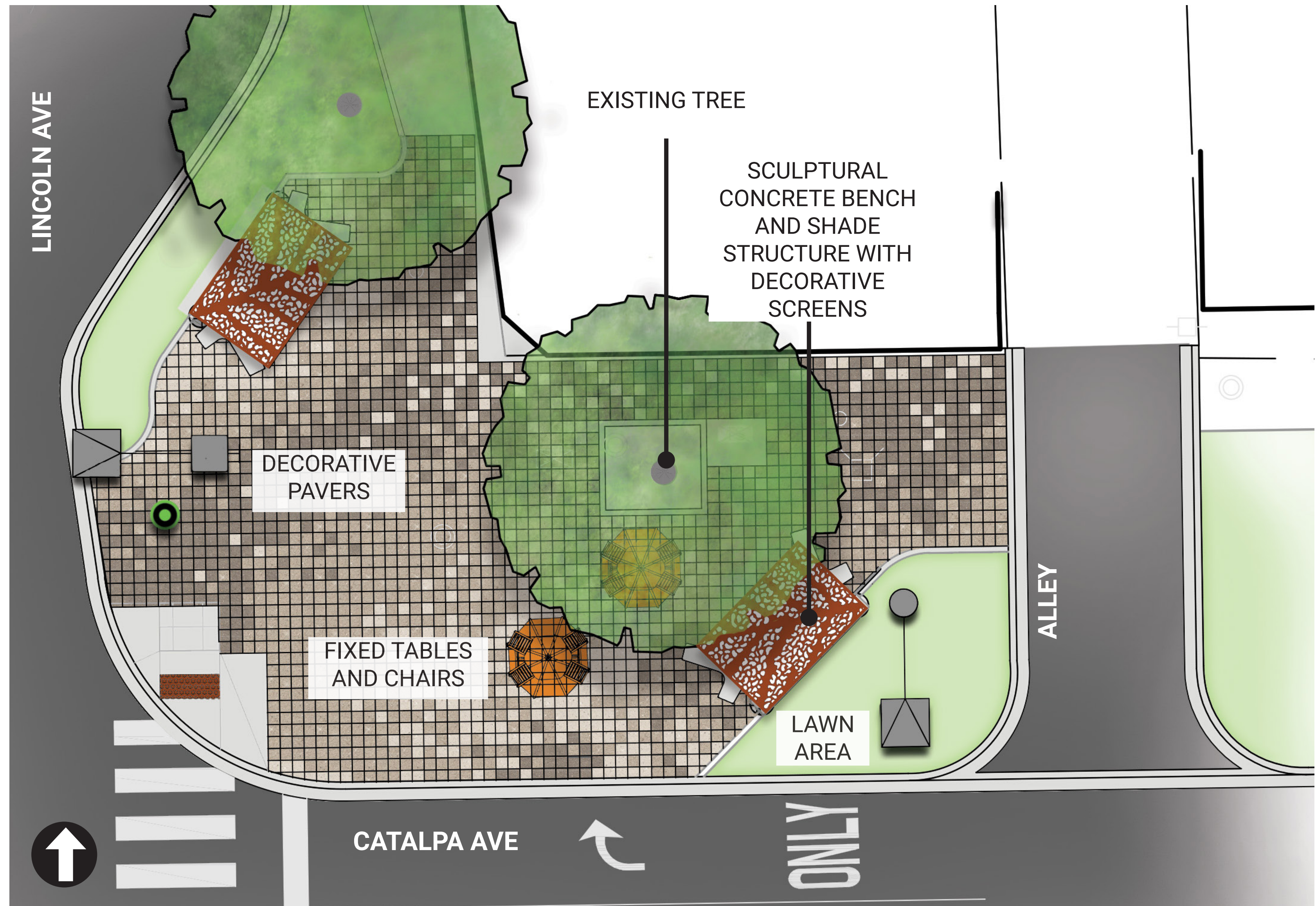

Materials + Products



Decorative Pavers



Fixed Table and Chairs With Sunshade

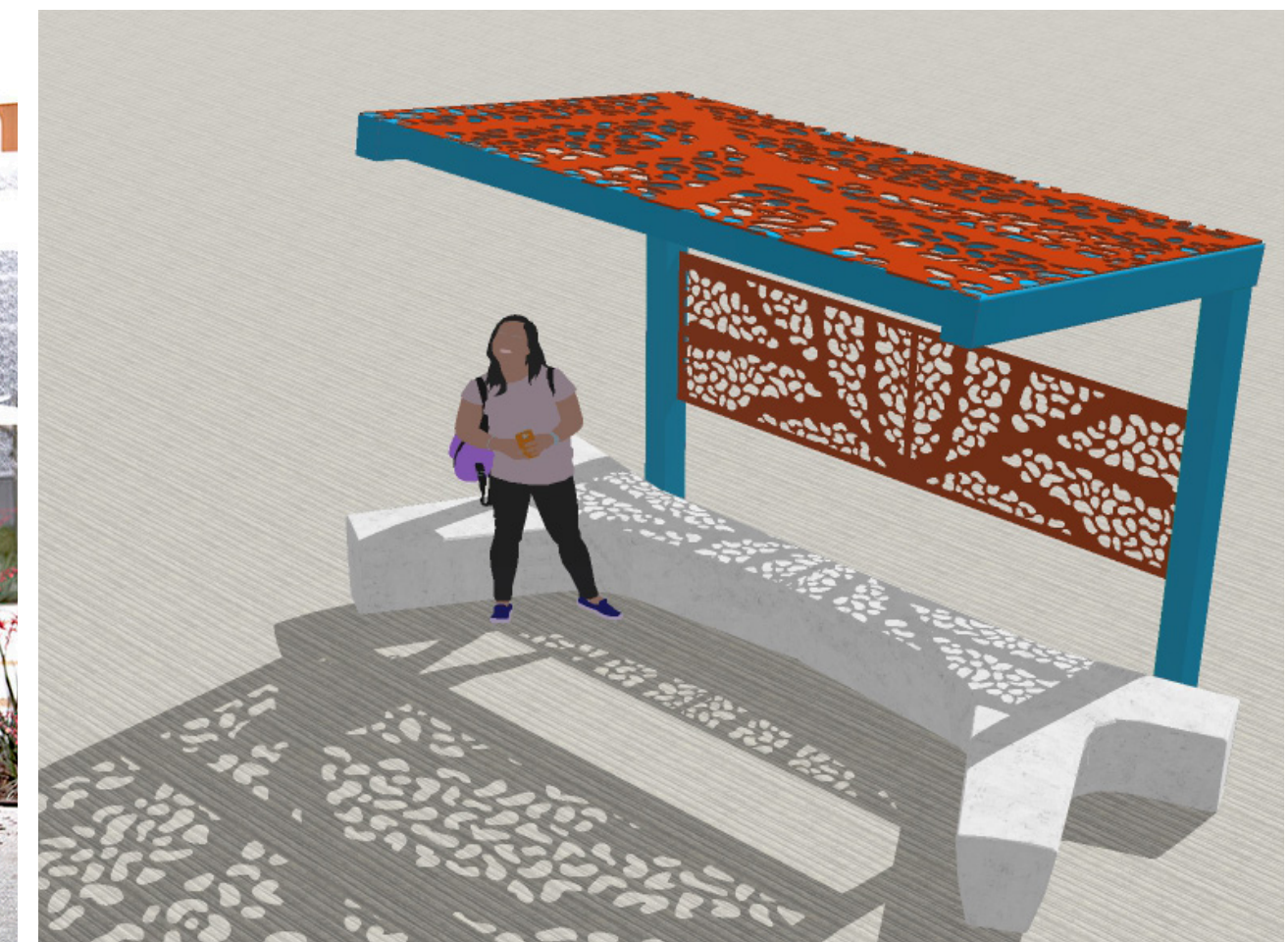

Sculptural Concrete Bench And Shade Structure With Decorative Screens

LINCOLN AVE STREETScape AND PLAZA



SECTION 2: LINCOLN AVENUE DESIGN + TYPICAL SECTION

Plan

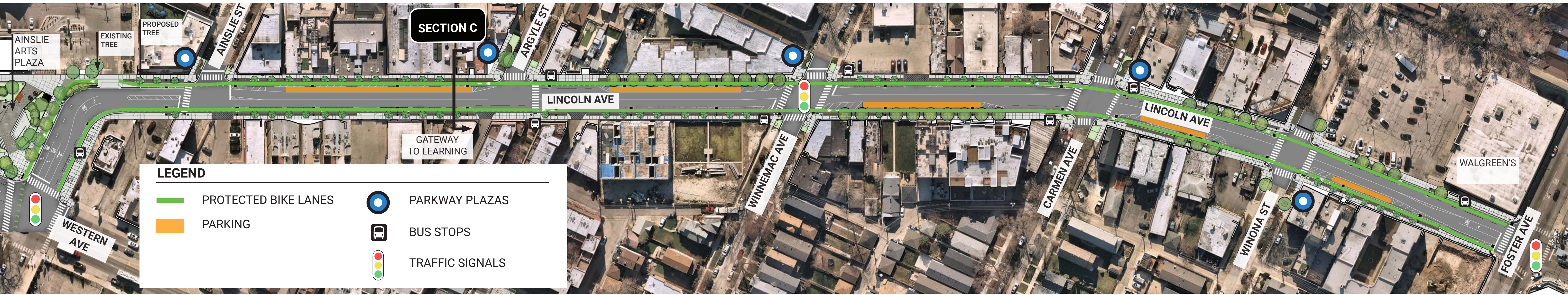

Lincoln Ave Existing

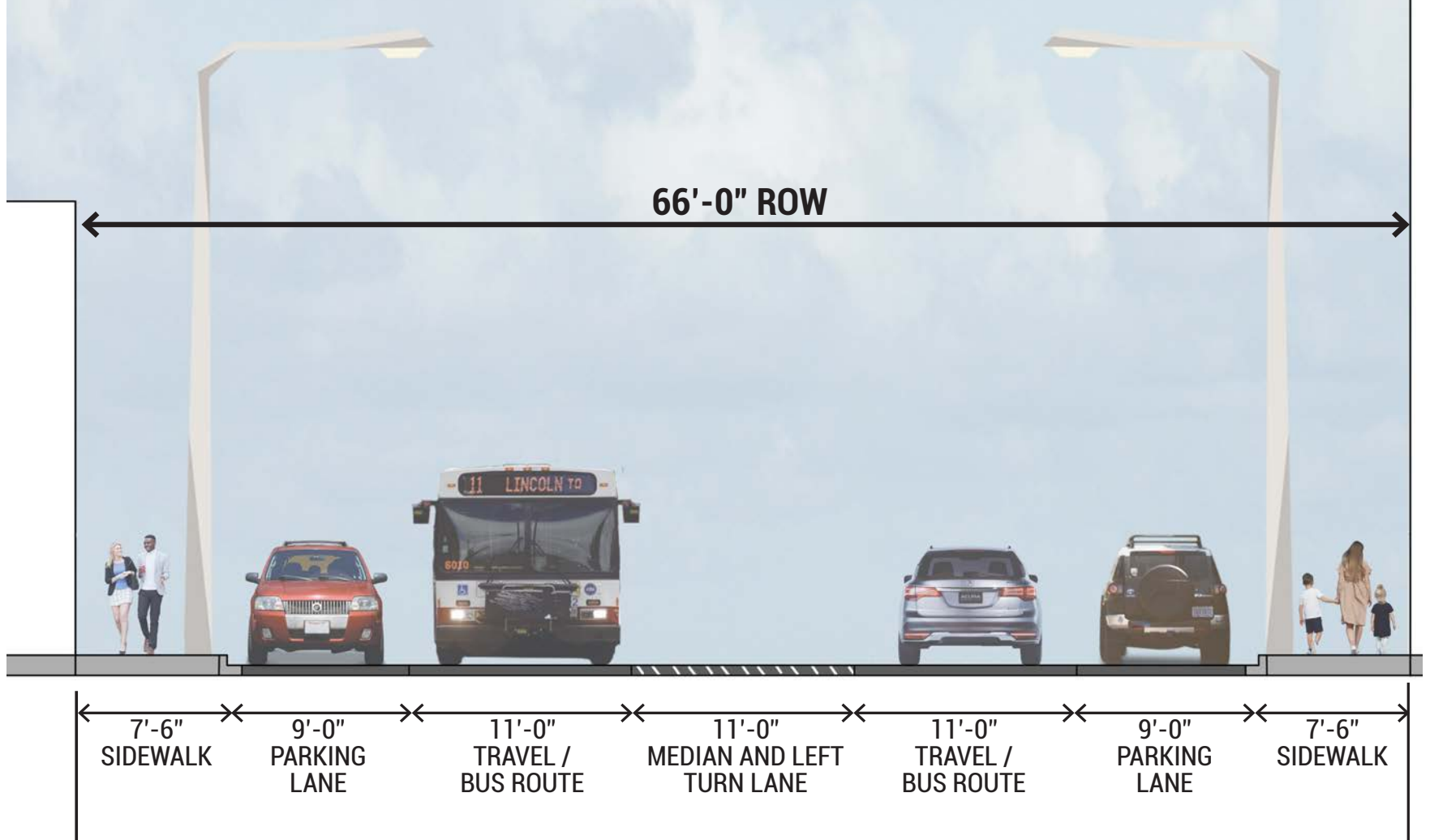

Lincoln Ave Proposed Section C

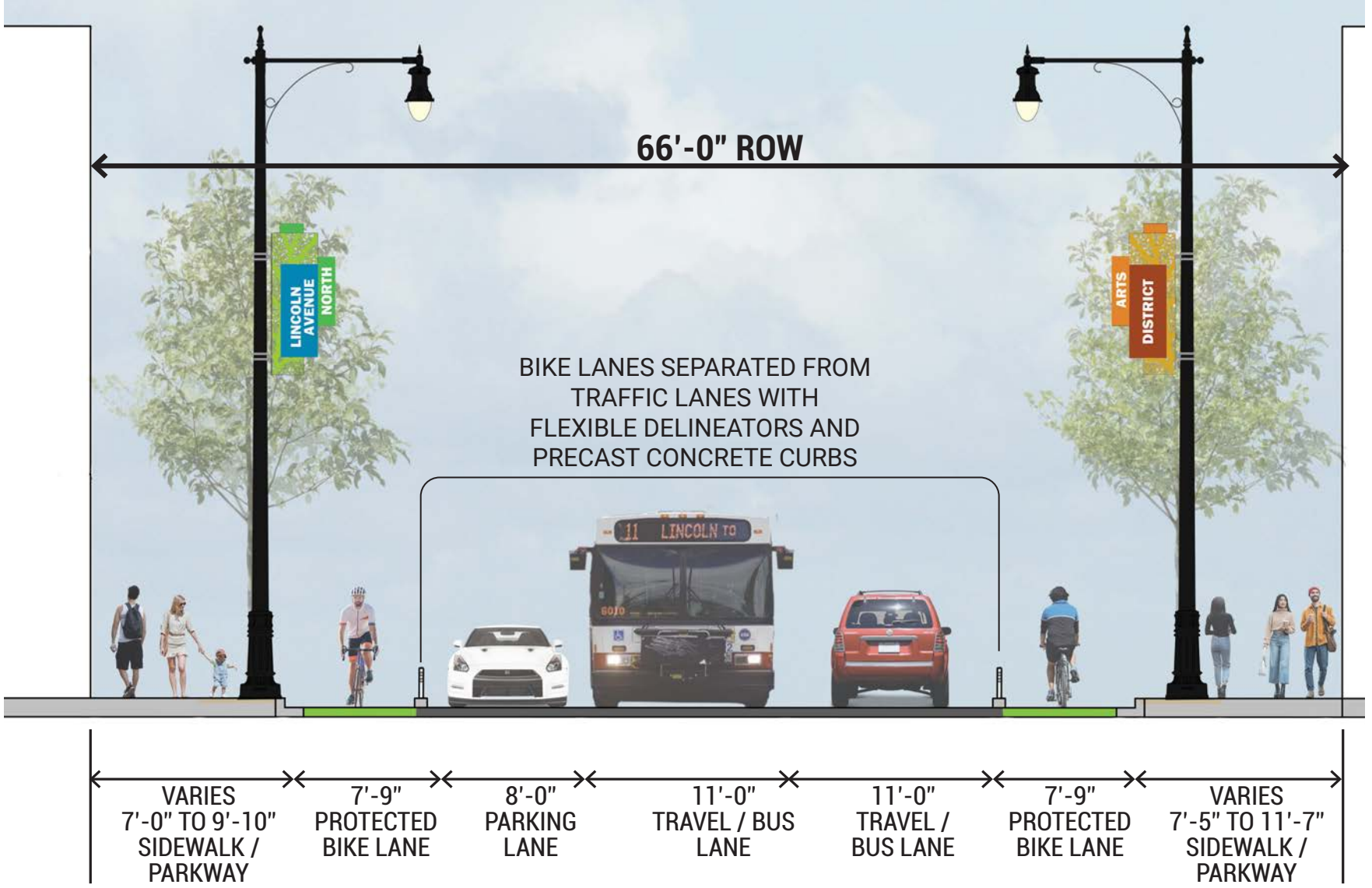

Typical Parkway Plaza Plan

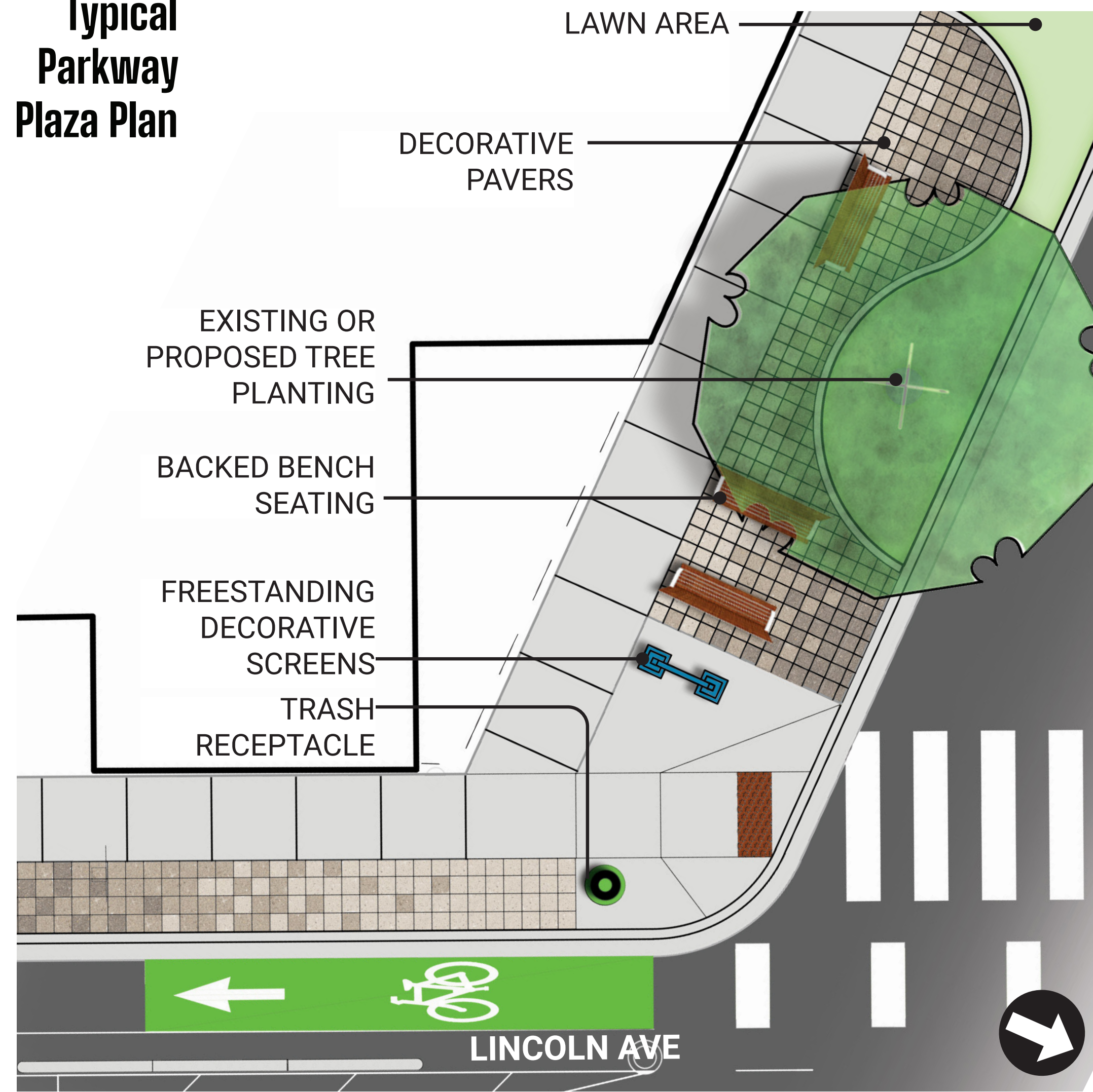

LINCOLN AVE STREETScape AND PLAZA



AINSLIE ARTS PLAZA

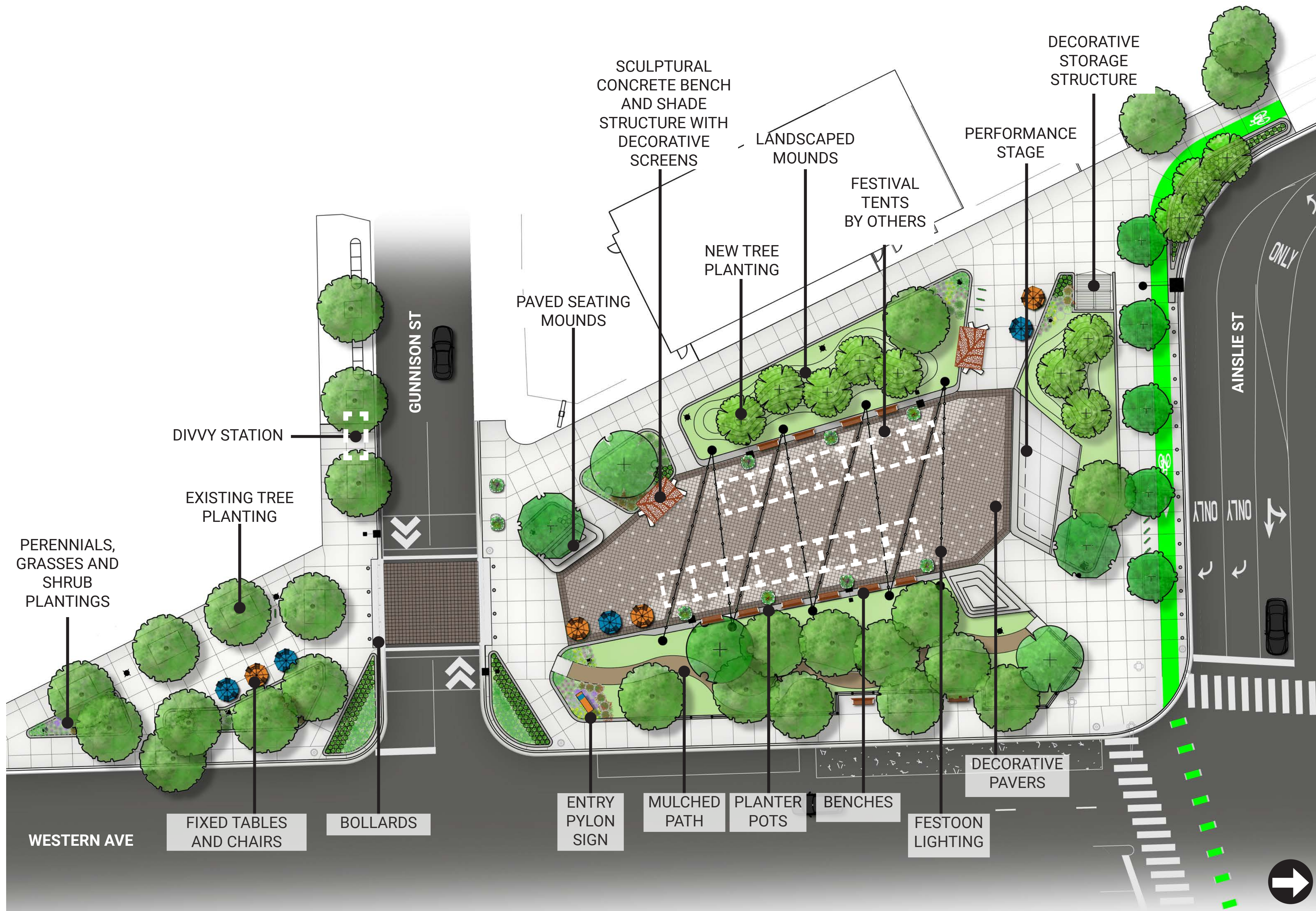

Ainslie Arts Plaza Plan

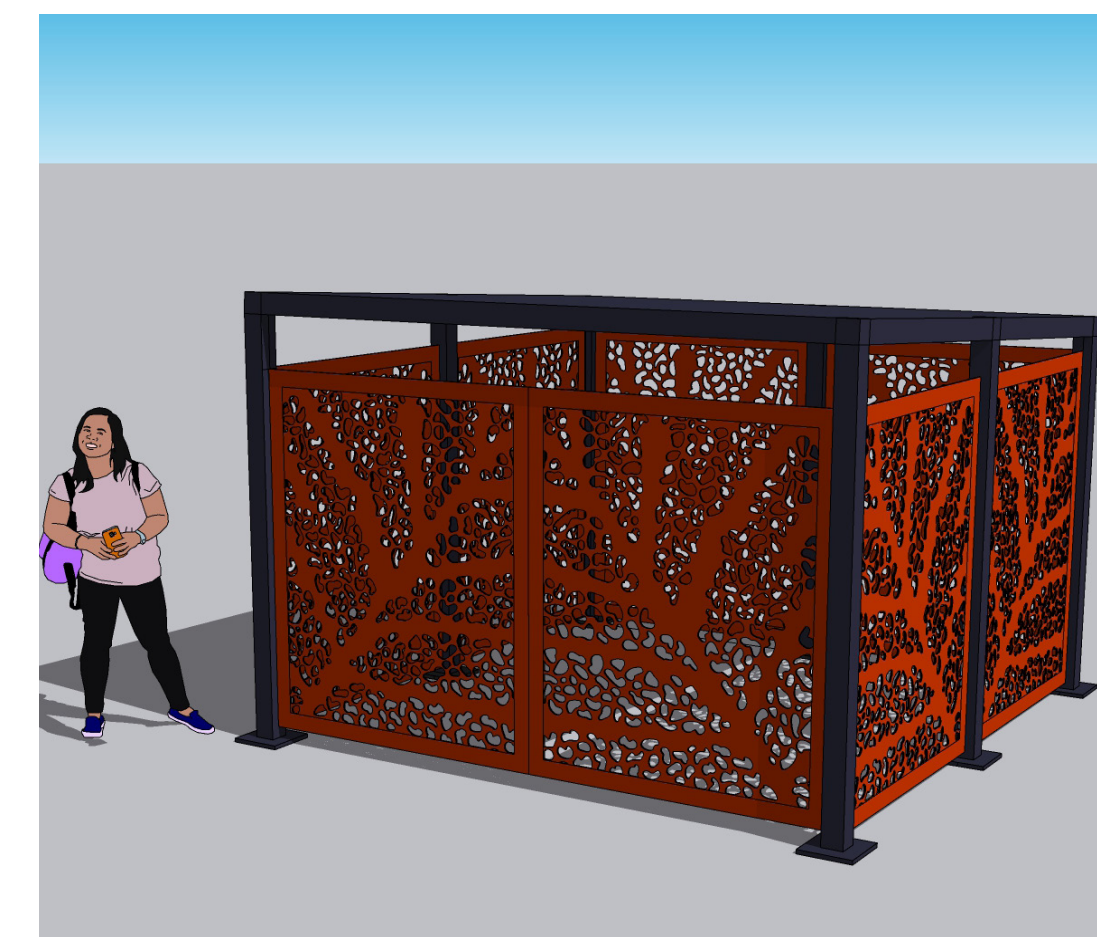

Storage Enclosure With Decorative Screens



Sculptural Concrete Bench And Shade Structure With Decorative Screens

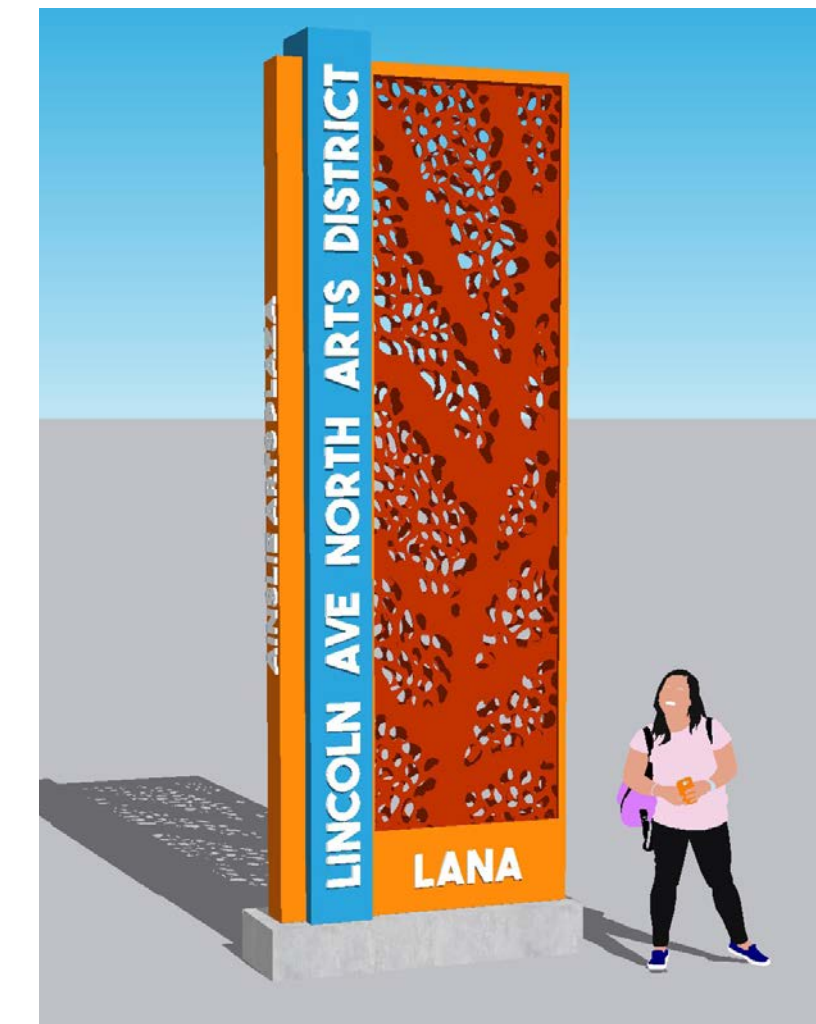

Gateway Pylon



Concrete Stage And Seating Mounds



Decorative Festoon Lighting



Fence With Decorative Screens

LINCOLN AVE STREETScape AND PLAZA



PROJECT RENDERINGS



Lincoln Avenue Streetscape – view looking south from Argyle St to Lincoln Ave



Catalpa Plaza – view looking north from Catalpa Ave to Lincoln Ave



Ainslie Arts Plaza – summer, daytime view looking north from plaza to Lincoln Ave



Ainslie Arts Plaza – winter, evening view looking north from plaza to Lincoln Ave

LINCOLN AVE STREETScape AND PLAZA

